



2 BHK

A	Living/ Dining	11'0" x 20'0"
B	Kitchen	14'9" x 8'6"
C	Common Toilet	7'0" x 4'6"
D	Terrace	89 sq.ft.~
E	Master Bedroom	13'0" x 10'9"
F	Master Toilet	7'0" x 4'6"
G	Bedroom	11'6" x 10'6"

Built-Up Area 932 sq.ft.
 Terrace Area 89 sq. ft.
 Saleable Area 977 sq.ft.

Built-up : Carpet area is 23 %

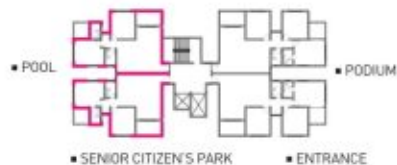

← ENTRANCE

APARTMENT TYPE B } ODD Floors } Terrace Adjoining Living Area

APARTMENT TYPE B

ODD FLOORS

12	1203	1204
11	1103	1104
10	1003	1004
9	903	904
8	803	804
7	703	704
6	603	604
5	503	504
4	403	404
3	303	304
2	203	204
1	103	104